

## Disk Type Load Cell

# ZLSW series

CAS, we have great know-how in weighing and control technology, we design and build our own Load Cell that provides high-accuracy repeatability and correct measurement even in harsh environment.



# CAS

# ZLSW



## Features

- Tensile / Compression type
- Hollow type
- Hermetically sealed structure
- Steel / Electroless nickel plating

## Application

- Compression tester

## Description

ZLSW is a low profile disk type load cell of steel material. It is suitable for compression tester and load control system.

## Specifications

Capacity(R.L.)		tf	1, 2, 2.5, 3, 5
Rated Output		mV / V	1.5 ± 0.05
Zero Balance		mV / V	0 ± 0.015
Accuracy Class		-	-
Non-Linearity		% R.O.	≤0.1
Hysteresis		% R.O.	≤0.1
Combined Error		% R.O.	≤0.1
Repeatability		% R.O.	≤0.05
Creep for 30min.		% R.O.	≤0.05
Return for 30min.		% R.O.	≤0.05
Resolution		-	-
Division		mV / V	-
Temperature Effect on	- Zero Value	%/10°C	±0.05
	- Span Value	%/10°C	±0.05
Excitation	- Recommended	V	10
	- Maximum	V	15
Resistance	- Input	Ω	700 ± 10
	- Output	Ω	700 ± 10
	- Insulation	MΩ	> 2000
Compensated Temperature Range		°C	-10 to +40
Operating Temperature Range		°C	-30 to +80
Material		-	Steel / Electroless Nickel Plating
Cable Specification		-	Ø5 X 4P X 40m (PVC)
Safety Overload		% R.L.	150

## Dimensions

Unit : mm

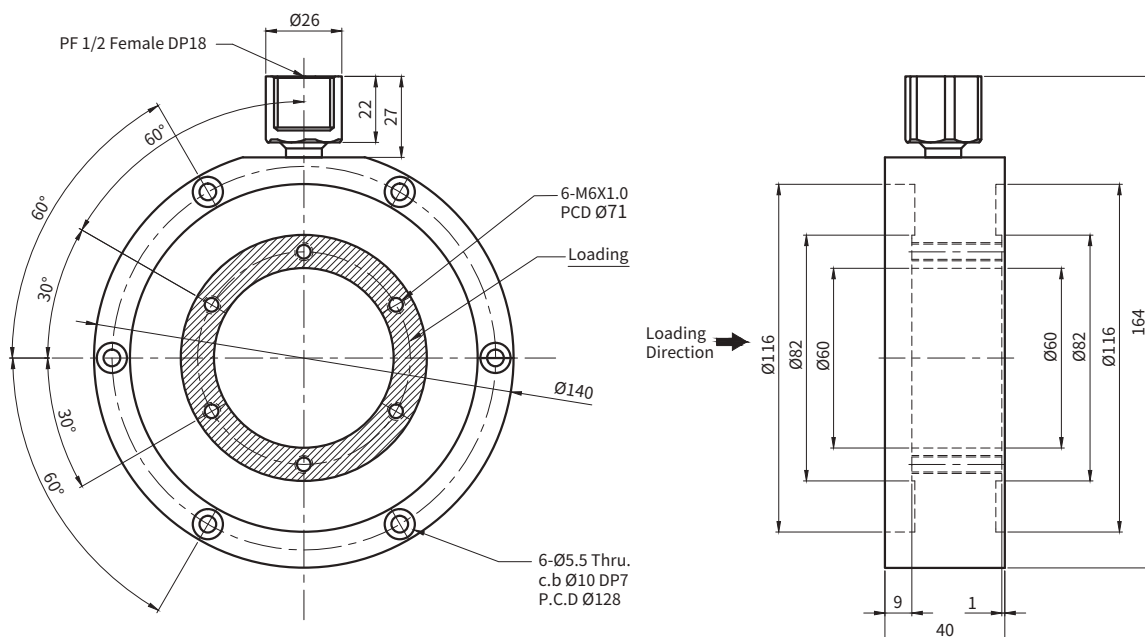





**CAS CORPORATION**

262, Geurugogae-ro, Gwangjeok-myeon,  
Yangju-si, Gyeonggi-do, Republic of Korea  
TEL: 82 31 820 1100

Website: [www.globalcas.com](http://www.globalcas.com) / [www.cas.co.kr](http://www.cas.co.kr)



\* Specifications are subject to change without notice improvement.

